

MODEL	0092 GLASS						
REFERENCE	0092160C01V1						
CUSTOMER REFERENCE							
DESCRIPTION	GLASS - CC160L175mm hdle PC+ temper glass						
	GLASS - Tir cr brill+cristal templado CC160L175						
MATERIAL	ZAMAK + GLASS						
FINISH	POLISHED CHROME + TEMPER GLASS						
LENGTH	175,00	WIDTH	31,00	HEIGHT	35,00	DIAMETER	0,00
UNIT WEIGHT	NET	0.215 kg		GROSS	0.2294 kg		
HOLES	TYPE		NUMBER OF HOLES		CC DISTANCE		
	M4		2		160 mm		
COMPONENTS							
REFERENCES	UNITS		REFERENCES		UNITS		
P0092035L01	2						
P0092160C01	1						

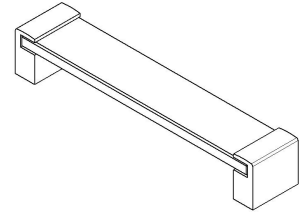

PACKAGING	VIEFE STAND								
LABEL				BOX					
EAN 13		EAN 14			INNER BOX	OUTER BOX			
BARCODE	8436531777357	BARCODE	18436531777354	PIECES	25	50			
POSITION	POLYBAG	POSITION	INNER BOX	DIMENSIONS	10x20x40cm	21x21x43cm			
				GROSS WEIGHT	5.735 kg	11.67 kg			
				SCREWS					
				TYPE				M4x25	
				UNITS				2	

### CONTROL POINTS AND REQUIREMENTS

- The handles have passed the salty spray test, DIN EN ISO 9227 (5% saline solution/48 hours). Test procedure "Neutral Salt Spray Test" (NSS).
- Dimensions according to drawing.
- Color finish according color samples signed by VIEFE.