

MODEL	0243 LOW ST						
REFERENCE	0243192Z01ST						
CUSTOMER REFERENCE							
DESCRIPTION	LOW ST - CC192L206mm pol chrome recess hdle						
	LOW - Tir. embutir cromo brillo CC192L206mm						
MATERIAL	ZINC ALLOY + STAINLESS STEEL						
FINISH	POLISHED CHROME						
LENGTH	206,00	WIDTH	52,00	HEIGHT	15,00	DIAMETER	0,00
UNIT WEIGHT	NET	0.18 kg		GROSS	0.2 kg		
HOLES	TYPE		NUMBER OF HOLES		CC DISTANCE		
	M4		2		192 mm		
COMPONENTS							
REFERENCES	UNITS		REFERENCES		UNITS		

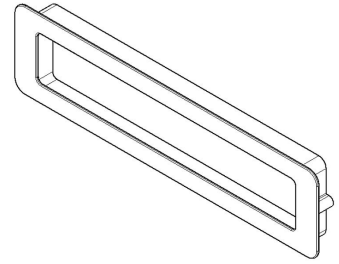

PACKAGING		VIEFE STAND							
LABEL				BOX					
EAN 13		EAN 14			INNER BOX	OUTER BOX			
BARCODE	8436531778644	BARCODE	18436531778641	PIECES	25	50			
POSITION	POLYBAG	POSITION	INNER BOX	DIMENSIONS	29,2x17,8x18,4cm	36,8x30,5x20cm			
				GROSS WEIGHT	5.0 kg	10.2 kg			
				SCREWS					
				TYPE		M4x12			
				UNITS		2			

CONTROL POINTS AND REQUIREMENTS
<ul style="list-style-type: none"> - The handles have passed the salty spray test, DIN EN ISO 9227 (5% saline solution/48 hours). Test procedure "Neutral Salt Spray Test" (NSS). - Dimensions according to drawing. - Color finish according color samples signed by VIEFE.