

MODEL	0249 FERRI						
REFERENCE	0249160S25						
CUSTOMER REFERENCE							
DESCRIPTION	FERRI - CC160L172mm brushed SST handle						
	FERRI - Asa inox cepillado CC160L172mm						
MATERIAL	STAINLESS STEEL						
FINISH	BRUSHED STAINLESS STEEL						
LENGTH	172,00	WIDTH	35,00	HEIGHT	12,00	DIAMETER	0,00
UNIT WEIGHT	NET	0.06 kg		GROSS	0.07 kg		
HOLES	TYPE		NUMBER OF HOLES		CC DISTANCE		
	M4		2		160 mm		
COMPONENTS							
REFERENCES	UNITS		REFERENCES		UNITS		

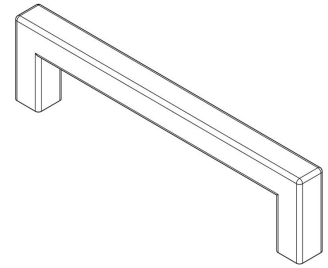

PACKAGING		VIEFE STAND							
LABEL				BOX					
EAN 13		EAN 14			INNER BOX	OUTER BOX			
BARCODE	8436531778019	BARCODE	18436531778016	PIECES	25	100			
POSITION	POLYBAG	POSITION	INNER BOX	DIMENSIONS	37x26x8cm	39x24x36cm			
				GROSS WEIGHT	1.75 kg	7.2 kg			
				SCREWS					
				TYPE		M4x25			
				UNITS		2			

CONTROL POINTS AND REQUIREMENTS
<ul style="list-style-type: none"> - The handles have passed the salty spray test, DIN EN ISO 9227 (5% saline solution/48 hours). Test procedure "Neutral Salt Spray Test" (NSS). - Dimensions according to drawing. - Color finish according color samples signed by VIEFE.