

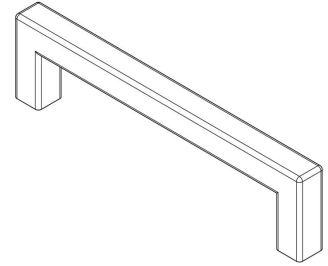
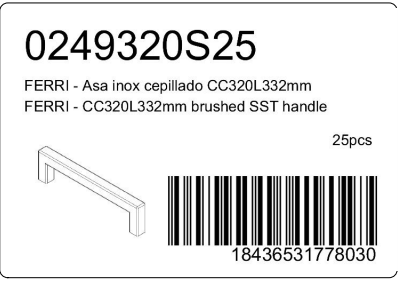

MODEL	0249 FERRI						
REFERENCE	0249320S25						
CUSTOMER REFERENCE							
DESCRIPTION	FERRI - CC320L332mm brushed SST handle						
	FERRI - Asa inox cepillado CC320L332mm						
MATERIAL	STAINLESS STEEL						
FINISH	BRUSHED STAINLESS STEEL						
LENGTH	332,00	WIDTH	35,00	HEIGHT	12,00	DIAMETER	0,00
UNIT WEIGHT	NET	0.12 kg			GROSS	0.13 kg	
HOLES	TYPE		NUMBER OF HOLES		CC DISTANCE		
	M4		2		320 mm		
COMPONENTS							
REFERENCES	UNITS		REFERENCES			UNITS	



PACKAGING	VIEFE STAND								
LABEL			BOX						
EAN 13		EAN 14			INNER BOX	OUTER BOX			
BARCODE	8436531778033	BARCODE	18436531778030	PIECES	25	100			
POSITION	POLYBAG	POSITION	INNER BOX	DIMENSIONS	42x37x8cm	42x39x20cm			
				GROSS WEIGHT			3.25 kg	13.2 kg	
				SCREWS					
				TYPE		M4x25			
UNITS		2							
									

CONTROL POINTS AND REQUIREMENTS
<ul style="list-style-type: none"> - The handles have passed the salty spray test, DIN EN ISO 9227 (5% saline solution/48 hours). Test procedure "Neutral Salt Spray Test" (NSS). - Dimensions according to drawing. - Color finish according color samples signed by VIEFE.