

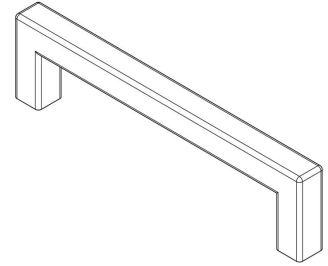
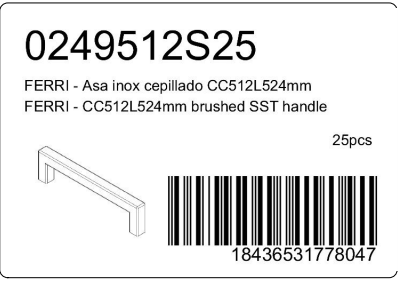

MODEL	0249 FERRI						
REFERENCE	0249512S25						
CUSTOMER REFERENCE							
DESCRIPTION	FERRI - CC512L524mm brushed SST handle						
	FERRI - Asa inox cepillado CC512L524mm						
MATERIAL	STAINLESS STEEL						
FINISH	BRUSHED STAINLESS STEEL						
LENGTH	524,00	WIDTH	35,00	HEIGHT	12,00	DIAMETER	0,00
UNIT WEIGHT	NET	0.156 kg			GROSS	0.165 kg	
HOLES	TYPE		NUMBER OF HOLES		CC DISTANCE		
	M4		2		512 mm		
COMPONENTS							
REFERENCES	UNITS		REFERENCES		UNITS		



PACKAGING		VIEFE STAND									
LABEL				BOX							
EAN 13		EAN 14			INNER BOX	OUTER BOX					
BARCODE	8436531778040	BARCODE	18436531778047	PIECES	25	50					
POSITION	POLYBAG	POSITION	INNER BOX	DIMENSIONS	60x37x8cm	62x39x20cm					
				GROSS WEIGHT				4.125 kg	8.45 kg		
				SCREWS							
				TYPE				M4x25			
				UNITS				2			
											

CONTROL POINTS AND REQUIREMENTS
<ul style="list-style-type: none"> - The handles have passed the salty spray test, DIN EN ISO 9227 (5% saline solution/48 hours). Test procedure "Neutral Salt Spray Test" (NSS). - Dimensions according to drawing. - Color finish according color samples signed by VIEFE.