

MODEL	0281 FLAT						
REFERENCE	0281160Z01						
CUSTOMER REFERENCE							
DESCRIPTION	FLAT - CC160L175mm pol chrome recess hdle						
	FLAT - Tir empot cromo brillo CC160L175mm						
MATERIAL	ZAMAK						
FINISH	POLISHED CHROME						
LENGTH	174,80	WIDTH	48,50	HEIGHT	19,70	DIAMETER	0,00
UNIT WEIGHT	NET	0.19 kg		GROSS	0.2106 kg		
HOLES	TYPE		NUMBER OF HOLES		CC DISTANCE		
	M4		2		160 mm		
COMPONENTS							
REFERENCES	UNITS		REFERENCES		UNITS		

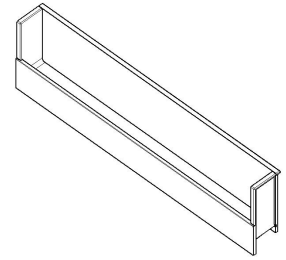

PACKAGING		VIEFE STAND									
LABEL				BOX							
EAN 13		EAN 14			INNER BOX	OUTER BOX					
BARCODE	8436531781446	BARCODE	18436531781443	PIECES	25	50					
POSITION	POLYBAG	POSITION	INNER BOX	DIMENSIONS	39,4x24,1x22,2cm	38,1x22,9x10,2cm					
				GROSS WEIGHT	5.265 kg	10.73 kg					
				SCREWS							
				TYPE				M4x12			
				UNITS				2			

CONTROL POINTS AND REQUIREMENTS
<ul style="list-style-type: none"> - The handles have passed the salty spray test, DIN EN ISO 9227 (5% saline solution/48 hours). Test procedure "Neutral Salt Spray Test" (NSS). - Dimensions according to drawing. - Color finish according color samples signed by VIEFE.