

MODEL	0410 BUTTON						
REFERENCE	0410160Z01						
CUSTOMER REFERENCE							
DESCRIPTION	BUTTON - CC160L175 polished chrome hdle						
	BUTTON - Tirador cromo brillo CC160L175mm						
MATERIAL	ZAMAK						
FINISH	POLISHED CHROME						
LENGTH	175,00	WIDTH	25,00	HEIGHT	17,00	DIAMETER	0,00
UNIT WEIGHT	NET	0.08 kg		GROSS	0.091 kg		
HOLES	TYPE		NUMBER OF HOLES		CC DISTANCE		
	M4		2		160 mm		
COMPONENTS							
REFERENCES	UNITS		REFERENCES		UNITS		

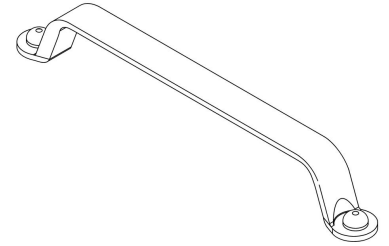

PACKAGING	VIEFE STAND								
LABEL				BOX					
EAN 13		EAN 14			INNER BOX	OUTER BOX			
BARCODE	8436531789916	BARCODE	18436531789913	PIECES	25	100			
POSITION	POLYBAG	POSITION	INNER BOX	DIMENSIONS	20,3x23,5x10,2cm	41,9x24,8x22,2cm			
				GROSS WEIGHT	2.275 kg	9.3 kg			
				SCREWS					
				TYPE				M4x25	
				UNITS				2	

CONTROL POINTS AND REQUIREMENTS
<ul style="list-style-type: none"> - The handles have passed the salty spray test, DIN EN ISO 9227 (5% saline solution/48 hours). Test procedure "Neutral Salt Spray Test" (NSS). - Dimensions according to drawing. - Color finish according color samples signed by VIEFE.