

MODEL	0410 BUTTON						
REFERENCE	0410160Z610						
CUSTOMER REFERENCE							
DESCRIPTION	BUTTON - CC160L175 pewter handle						
	BUTTON - Tirador peltre CC160L175mm						
MATERIAL	ZAMAK						
FINISH	PEWTER						
LENGTH	175,00	WIDTH	25,00	HEIGHT	17,00	DIAMETER	0,00
UNIT WEIGHT	NET	0.08 kg		GROSS	0.091 kg		
HOLES	TYPE		NUMBER OF HOLES		CC DISTANCE		
	M4		2		160 mm		
COMPONENTS							
REFERENCES	UNITS		REFERENCES		UNITS		

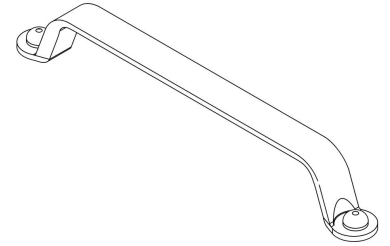

PACKAGING	VIEFE STAND									
LABEL				BOX						
EAN 13		EAN 14			INNER BOX	OUTER BOX				
BARCODE	8436531788285	BARCODE	18436531788282	PIECES	25	100				
POSITION	POLYBAG	POSITION	INNER BOX	DIMENSIONS	20,3x23,5x10,2cm	41,9x24,8x22,2cm				
				GROSS WEIGHT	2.275 kg	9.3 kg				
				SCREWS						
								TYPE	M4x25	
								UNITS	2	

CONTROL POINTS AND REQUIREMENTS

- The handles have passed the salty spray test, DIN EN ISO 9227 (5% saline solution/48 hours). Test procedure "Neutral Salt Spray Test" (NSS).
- Dimensions according to drawing.
- Color finish according color samples signed by VIEFE.