

MODEL	0459 LINES						
REFERENCE	0459160Z32						
CUSTOMER REFERENCE							
DESCRIPTION	LINES - CC160L170mm brushed mole grey hdle						
	LINES - tir gris topo cepillado CC160L170mm						
MATERIAL	ZAMAK						
FINISH	BRUSHED GREY MOLE						
LENGTH	170,00	WIDTH	30,00	HEIGHT	17,00	DIAMETER	0,00
UNIT WEIGHT	NET	0.1081 kg		GROSS	0.117 kg		
HOLES	TYPE		NUMBER OF HOLES		CC DISTANCE		
	M4		2		160 mm		
COMPONENTS							
REFERENCES	UNITS		REFERENCES		UNITS		

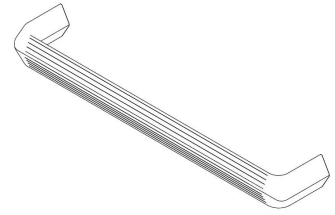

PACKAGING	VIEFE STAND								
LABEL				BOX					
EAN 13		EAN 14			INNER BOX	OUTER BOX			
BARCODE	8436531796860	BARCODE	18436531796867	PIECES	25	100			
POSITION	POLYBAG	POSITION	INNER BOX	DIMENSIONS	22,5x14,5x10,5cm	31x24,5x23cm			
				GROSS WEIGHT	2.925 kg	11.9 kg			
				SCREWS					
				TYPE				M4x25	
				UNITS				2	

CONTROL POINTS AND REQUIREMENTS
<ul style="list-style-type: none"> - The handles have passed the salty spray test, DIN EN ISO 9227 (5% saline solution/48 hours). Test procedure "Neutral Salt Spray Test" (NSS). - Dimensions according to drawing. - Color finish according color samples signed by VIEFE.