

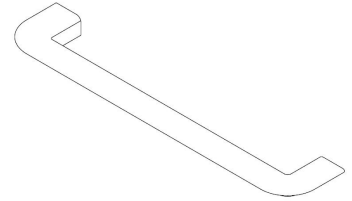

MODEL	0480 NICE						
REFERENCE	0480160Z32						
CUSTOMER REFERENCE							
DESCRIPTION	NICE-Brushed mole grey handle CC160L185mm						
	NICE - tir gris topo cepillado CC160L185mm						
MATERIAL	ZAMAK						
FINISH	BRUSHED GREY MOLE						
LENGTH	184,60	WIDTH	36,40	HEIGHT	10,30	DIAMETER	0,00
UNIT WEIGHT	NET	0.13 kg		GROSS	0.15 kg		
HOLES	TYPE		NUMBER OF HOLES		CC DISTANCE		
	M4		2		160 mm		
COMPONENTS							
REFERENCES	UNITS		REFERENCES		UNITS		



PACKAGING	VIEFE STAND									
LABEL				BOX						
EAN 13		EAN 14			INNER BOX	OUTER BOX				
BARCODE	8436531799106	BARCODE	18436531799103	PIECES	25	75				
POSITION	POLYBAG	POSITION	INNER BOX	DIMENSIONS	25x15x10,5cm	27x17x33,5cm				
				GROSS WEIGHT	3.75 kg	11.45 kg				
				SCREWS						
								TYPE		M4x25
								UNITS		2

### CONTROL POINTS AND REQUIREMENTS

- The handles have passed the salty spray test, DIN EN ISO 9227 (5% saline solution/48 hours). Test procedure "Neutral Salt Spray Test" (NSS).
- Dimensions according to drawing.
- Color finish according color samples signed by VIEFE.