

MODEL	0556 DIPO						
REFERENCE	0556070ZM2						
CUSTOMER REFERENCE							
DESCRIPTION	DIPO - D70mm matt black recessed pull						
	DIPO - Tir empotrar negro mate D70mm						
MATERIAL	ZAMAK						
FINISH	MATT BLACK						
LENGTH	0,00	WIDTH	20,00	HEIGHT	0,00	DIAMETER	74,00
UNIT WEIGHT	NET	0.085 kg		GROSS	0.105 kg		
HOLES	TYPE		NUMBER OF HOLES		CC DISTANCE		
	M4		1		- mm		
COMPONENTS							
REFERENCES	UNITS		REFERENCES		UNITS		

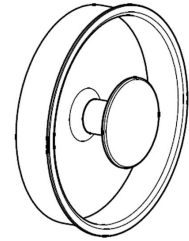

PACKAGING	VIEFE STAND								
LABEL				BOX					
EAN 13		EAN 14			INNER BOX	OUTER BOX			
BARCODE	8436531806774	BARCODE	18436531806771	PIECES	25	100			
POSITION	POLYBAG	POSITION	INNER BOX	DIMENSIONS	27x22,5x10,5cm	47,5x29x23,5cm			
				GROSS WEIGHT	2.625 kg	10.7 kg			
				SCREWS					
				TYPE				M4x12	
				UNITS				1	

CONTROL POINTS AND REQUIREMENTS

- The handles have passed the salty spray test, DIN EN ISO 9227 (5% saline solution/48 hours). Test procedure "Neutral Salt Spray Test" (NSS).
- Dimensions according to drawing.
- Color finish according color samples signed by VIEFE.