

MODEL	ARPA PLATE						
REFERENCE	0588070L24						
CUSTOMER REFERENCE							
DESCRIPTION	ARPA plate - 70x25mm stainless steel look T knob						
	ARPA plate - Pomo T inox look 70x25mm						
MATERIAL	ALUMINIUM						
FINISH	STAINLESS STEEL LOOK						
LENGTH	70,00	WIDTH	37,00	HEIGHT	25,00	DIAMETER	0,00
UNIT WEIGHT	NET	0.04 kg		GROSS	0.055 kg		
HOLES	TYPE		NUMBER OF HOLES		CC DISTANCE		
	M4		1		- mm		
COMPONENTS							
REFERENCES	UNITS		REFERENCES		UNITS		

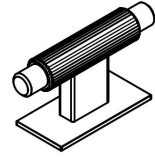

PACKAGING	VIEFE STAND								
LABEL				BOX					
EAN 13		EAN 14			INNER BOX	OUTER BOX			
BARCODE	8436531808891	BARCODE	18436531808898	PIECES	25	200			
POSITION	POLYBAG	POSITION	INNER BOX	DIMENSIONS	16x16x10cm	34x34x22cm			
				GROSS WEIGHT	1.375 kg	11.2 kg			
				SCREWS					
				TYPE				M4x25	
				UNITS				1	

### CONTROL POINTS AND REQUIREMENTS

- The handles have passed the salty spray test, DIN EN ISO 9227 (5% saline solution/48 hours). Test procedure "Neutral Salt Spray Test" (NSS).
- Dimensions according to drawing.
- Color finish according color samples signed by VIEFE.