

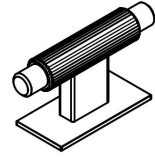

| | | | | | | | |
|--------------------|---|---------|-----------------|--------|-------------|----------|------|
| MODEL | ARPA PLATE | | | | | | |
| REFERENCE | 0588070L291 | | | | | | |
| CUSTOMER REFERENCE | | | | | | | |
| DESCRIPTION | ARPA plate - 70x25mm brushed dark brass T knob | | | | | | |
| | ARPA plate - Pomo T latón osc cepillado 70x25mm | | | | | | |
| MATERIAL | ALUMINIUM | | | | | | |
| FINISH | BRUSHED DARK BRASS | | | | | | |
| LENGTH | 70,00 | WIDTH | 37,00 | HEIGHT | 25,00 | DIAMETER | 0,00 |
| UNIT WEIGHT | NET | 0.04 kg | | GROSS | 0.055 kg | | |
| HOLES | TYPE | | NUMBER OF HOLES | | CC DISTANCE | | |
| | M4 | | 1 | | - mm | | |
| COMPONENTS | | | | | | | |
| REFERENCES | UNITS | | REFERENCES | | UNITS | | |
| | | | | | | | |
| | | | | | | | |
| | | | | | | | |



| | | | | | | | | | | |
|--|---------------|----------|----------------|--|------------|------------|--|-------|--|-------|
| PACKAGING | VIEFE STAND | | | | | | | | | |
| LABEL | | | | BOX | | | | | | |
| EAN 13 | | EAN 14 | | | INNER BOX | OUTER BOX | | | | |
| BARCODE | 8436531808907 | BARCODE | 18436531808904 | PIECES | 25 | 200 | | | | |
| POSITION | POLYBAG | POSITION | INNER BOX | DIMENSIONS | 16x16x10cm | 34x34x22cm | | | | |
|  | | | | GROSS WEIGHT | 1.375 kg | 11.2 kg | | | | |
| | | | | SCREWS | | | | | | |
| | | | |  | | | | TYPE | | M4x25 |
| | | | | | | | | UNITS | | 1 |

CONTROL POINTS AND REQUIREMENTS

- The handles have passed the salty spray test, DIN EN ISO 9227 (5% saline solution/48 hours). Test procedure "Neutral Salt Spray Test" (NSS).
- Dimensions according to drawing.
- Color finish according color samples signed by VIEFE.