

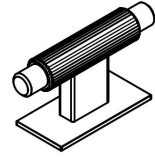

MODEL	ARPA PLATE						
REFERENCE	0588070L30						
CUSTOMER REFERENCE							
DESCRIPTION	ARPA plate - 70x25mm brushed black T knob						
	ARPA plate - Pomo T negro cepillado 70x25mm						
MATERIAL	ALUMINIUM						
FINISH	BRUSHED BLACK						
LENGTH	70,00	WIDTH	37,00	HEIGHT	25,00	DIAMETER	0,00
UNIT WEIGHT	NET	0.04 kg		GROSS	0.055 kg		
HOLES	TYPE		NUMBER OF HOLES		CC DISTANCE		
	M4		1		- mm		
COMPONENTS							
REFERENCES	UNITS		REFERENCES		UNITS		



PACKAGING	VIEFE STAND									
LABEL				BOX						
EAN 13		EAN 14			INNER BOX	OUTER BOX				
BARCODE	8436531808914	BARCODE	18436531808911	PIECES	25	200				
POSITION	POLYBAG	POSITION	INNER BOX	DIMENSIONS	16x16x10cm	34x34x22cm				
				GROSS WEIGHT	1.375 kg	11.2 kg				
				SCREWS						
								TYPE	M4x25	
								UNITS	1	

CONTROL POINTS AND REQUIREMENTS

- The handles have passed the salty spray test, DIN EN ISO 9227 (5% saline solution/48 hours). Test procedure "Neutral Salt Spray Test" (NSS).
- Dimensions according to drawing.
- Color finish according color samples signed by VIEFE.