

MODEL	6003 JAZZ						
REFERENCE	6003045Z01						
CUSTOMER REFERENCE							
DESCRIPTION	JAZZ - 91mm feet polished chrome						
	JAZZ - Pata cromo brillo 91mm						
MATERIAL	ALUMINIUM						
FINISH	POLISHED CHROME						
LENGTH	60,00	WIDTH	91,00	HEIGHT	79,00	DIAMETER	0,00
UNIT WEIGHT	NET	0.0 kg			GROSS	0.45 kg	
HOLES	TYPE		NUMBER OF HOLES		CC DISTANCE		
			0		- mm		
COMPONENTS							
REFERENCES	UNITS		REFERENCES		UNITS		

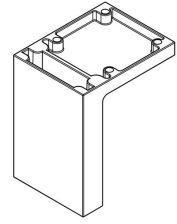

PACKAGING	VIEFE 1 COMP.								
LABEL				BOX					
EAN 13		EAN 14			INNER BOX	OUTER BOX			
BARCODE	8436531773175	BARCODE	18436531773172	PIECES	2	24			
POSITION	POLYBAG	POSITION	INNER BOX	DIMENSIONS	50,8x14x15,2cm	52,1x15,2x16,8cm			
				GROSS WEIGHT	0.9 kg	11.0 kg			
				SCREWS					
				TYPE					
				UNITS					

CONTROL POINTS AND REQUIREMENTS
<ul style="list-style-type: none"> - The handles have passed the salty spray test, DIN EN ISO 9227 (5% saline solution/48 hours). Test procedure "Neutral Salt Spray Test" (NSS). - Dimensions according to drawing. - Color finish according color samples signed by VIEFE.