

MODEL	6005 FONDA						
REFERENCE	6005100L29						
CUSTOMER REFERENCE							
DESCRIPTION	FONDA - 100mm feet w/regulator brushed dark brass						
	FONDA - Pata c/regulador latón osc. cepillado 100mm						
MATERIAL	ALUMINIUM						
FINISH	DARK BRASS						
LENGTH	60,00	WIDTH	100,00	HEIGHT	80,00	DIAMETER	0,00
UNIT WEIGHT	NET	0.245 kg		GROSS	0.265 kg		
HOLES	TYPE		NUMBER OF HOLES		CC DISTANCE		
	ø5.5		0		32/44 mm		
COMPONENTS							
REFERENCES	UNITS		REFERENCES		UNITS		

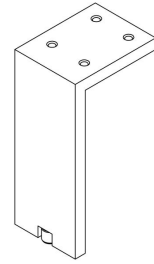

PACKAGING	VIEFE STAND								
LABEL				BOX					
EAN 13		EAN 14			INNER BOX	OUTER BOX			
BARCODE	8436531801861	BARCODE	18436531801868	PIECES	2	24			
POSITION	POLYBAG	POSITION	INNER BOX	DIMENSIONS	11x10x7cm	24x22x23cm			
				GROSS WEIGHT	0.53 kg	6.56 kg			
				SCREWS					
				TYPE		-			
				UNITS		0			

CONTROL POINTS AND REQUIREMENTS
<ul style="list-style-type: none"> - The handles have passed the salty spray test, DIN EN ISO 9227 (5% saline solution/48 hours). Test procedure "Neutral Salt Spray Test" (NSS). - Dimensions according to drawing. - Color finish according color samples signed by VIEFE.