

| | | | | | | | |
|--------------------|------------------------------------------------|----------|-----------------|--------|-------------|----------|------|
| MODEL | 6005 FONDA | | | | | | |
| REFERENCE | 6005100L30 | | | | | | |
| CUSTOMER REFERENCE | | | | | | | |
| DESCRIPTION | FONDA - 100mm feet w/regulator brushed black | | | | | | |
| | FONDA - Pata c/regulador negro cepillado 100mm | | | | | | |
| MATERIAL | ALUMINIUM | | | | | | |
| FINISH | BRUSHED BLACK | | | | | | |
| LENGTH | 60,00 | WIDTH | 100,00 | HEIGHT | 80,00 | DIAMETER | 0,00 |
| UNIT WEIGHT | NET | 0.245 kg | | GROSS | 0.265 kg | | |
| HOLES | TYPE | | NUMBER OF HOLES | | CC DISTANCE | | |
| | ø5.5 | | 0 | | 32/44 mm | | |
| COMPONENTS | | | | | | | |
| REFERENCES | UNITS | | REFERENCES | | UNITS | | |
| | | | | | | | |
| | | | | | | | |

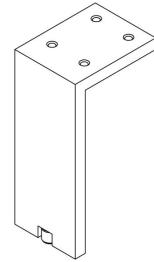

| | | | | | | | | | |
|-----------|---------------|----------|----------------|--------------|-----------|------------|--|---|--|
| PACKAGING | VIEFE STAND | | | | | | | | |
| LABEL | | | | BOX | | | | | |
| EAN 13 | | EAN 14 | | | INNER BOX | OUTER BOX | | | |
| BARCODE | 8436531793524 | BARCODE | 18436531793521 | PIECES | 2 | 24 | | | |
| POSITION | POLYBAG | POSITION | INNER BOX | DIMENSIONS | 11x10x7cm | 24x22x23cm | | | |
| | | | | GROSS WEIGHT | 0.53 kg | 6.56 kg | | | |
| | | | | SCREWS | | | | | |
| | | | | TYPE | | | | - | |
| | | | | UNITS | | | | 0 | |

CONTROL POINTS AND REQUIREMENTS

- The handles have passed the salty spray test, DIN EN ISO 9227 (5% saline solution/48 hours). Test procedure "Neutral Salt Spray Test" (NSS).
- Dimensions according to drawing.
- Color finish according color samples signed by VIEFE.