

MODEL	6005 FONDA						
REFERENCE	6005150L01						
CUSTOMER REFERENCE							
DESCRIPTION	FONDA - 150mm feet w/regulator pol chrome						
	FONDA - Pata c/regulador cromo brillo 150mm						
MATERIAL	ALUMINIUM						
FINISH	POLISHED CHROME						
LENGTH	60,00	WIDTH	150,00	HEIGHT	80,00	DIAMETER	0,00
UNIT WEIGHT	NET	0.33 kg		GROSS	0.35 kg		
HOLES	TYPE		NUMBER OF HOLES		CC DISTANCE		
	ø5.5		0		32/44 mm		
COMPONENTS							
REFERENCES	UNITS		REFERENCES		UNITS		

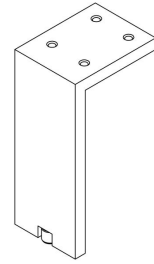

PACKAGING	VIEFE STAND								
LABEL				BOX					
EAN 13		EAN 14			INNER BOX	OUTER BOX			
BARCODE	8436531780258	BARCODE	18436531780255	PIECES	2	24			
POSITION	POLYBAG	POSITION	INNER BOX	DIMENSIONS	13x8,9x7cm	28,5x28,5x16cm			
				GROSS WEIGHT	0.7 kg	8.6 kg			
				SCREWS					
				TYPE				-	
				UNITS					

CONTROL POINTS AND REQUIREMENTS
<ul style="list-style-type: none"> - The handles have passed the salty spray test, DIN EN ISO 9227 (5% saline solution/48 hours). Test procedure "Neutral Salt Spray Test" (NSS). - Dimensions according to drawing. - Color finish according color samples signed by VIEFE.