

MODEL	6005 FONDA						
REFERENCE	6005150L24						
CUSTOMER REFERENCE							
DESCRIPTION	FONDA - 150mm feet w/regulator SST look						
	FONDA - Pata c/regulador inox look 150mm						
MATERIAL	ALUMINIUM						
FINISH	STAINLESS STEEL LOOK						
LENGTH	60,00	WIDTH	150,00	HEIGHT	80,00	DIAMETER	0,00
UNIT WEIGHT	NET	0.33 kg		GROSS	0.35 kg		
HOLES	TYPE		NUMBER OF HOLES		CC DISTANCE		
	ø5.5		0		32/44 mm		
COMPONENTS							
REFERENCES	UNITS		REFERENCES		UNITS		

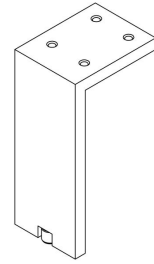

PACKAGING	VIEFE STAND								
LABEL				BOX					
EAN 13		EAN 14			INNER BOX	OUTER BOX			
BARCODE	8436531780265	BARCODE	18436531780262	PIECES	2	24			
POSITION	POLYBAG	POSITION	INNER BOX	DIMENSIONS	16x10x7cm	34x22x23cm			
				GROSS WEIGHT	0.7 kg	8.6 kg			
				SCREWS					
				TYPE		-			
				UNITS		0			

CONTROL POINTS AND REQUIREMENTS
<ul style="list-style-type: none"> <li>- The handles have passed the salty spray test, DIN EN ISO 9227 (5% saline solution/48 hours). Test procedure "Neutral Salt Spray Test" (NSS).</li> <li>- Dimensions according to drawing.</li> <li>- Color finish according color samples signed by VIEFE.</li> </ul>