

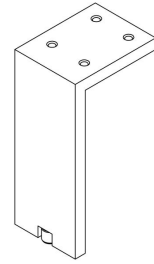

MODEL	6005 FONDA						
REFERENCE	6005150L29						
CUSTOMER REFERENCE							
DESCRIPTION	FONDA - 150mm feet w/regulator brushed dark brass						
	FONDA - Pata c/regulador latón osc. cepillado 150mm						
MATERIAL	ALUMINIUM						
FINISH	DARK BRASS						
LENGTH	60,00	WIDTH	150,00	HEIGHT	80,00	DIAMETER	0,00
UNIT WEIGHT	NET	0.33 kg		GROSS	0.35 kg		
HOLES	TYPE		NUMBER OF HOLES		CC DISTANCE		
	ø5.5		0		32/44 mm		
COMPONENTS							
REFERENCES	UNITS		REFERENCES		UNITS		



PACKAGING	VIEFE STAND									
LABEL				BOX						
EAN 13		EAN 14			INNER BOX	OUTER BOX				
BARCODE	8436531801854	BARCODE	18436531801851	PIECES	2	24				
POSITION	POLYBAG	POSITION	INNER BOX	DIMENSIONS	16x10x7cm	34x22x23cm				
				GROSS WEIGHT	0.7 kg	8.6 kg				
				SCREWS						
								TYPE		-
								UNITS		0

### CONTROL POINTS AND REQUIREMENTS

- The handles have passed the salty spray test, DIN EN ISO 9227 (5% saline solution/48 hours). Test procedure "Neutral Salt Spray Test" (NSS).
- Dimensions according to drawing.
- Color finish according color samples signed by VIEFE.